

The channel system

for barrier-free threshold systems

ACO Profiline Free

PremiPlan® and PremiPlan® Plus from Profine



ACO Profiline Free

The demand for plan-related specifications for barrier-free transitions exists not only on the part of DIN 18531/18533 but also from the Flat Roof Directive. The planner still however faces many challenges during implementation with regard to the interfaces between the individual subjects regarding “door, waterproofing and drainage”. For this reason, the Profiline, Alwitra and ACO Hochbau companies have started a project to develop a so-called zero threshold. As already demanded by AIBau in 2010, the focus was hereby

placed on the design of details which are easy to execute by manual workers and/or pre-prepared safe connections for the sealing and waterproofing.

The ACO Profiline Free drainage system, which was specially developed and tested for this purpose, is available as an open channel system for roofs, balconies, loggias and pergola walkways which are used for foot traffic in accordance with DIN 18531 and as a closed channel system for areas in contact with the ground in accordance with DIN 18533.

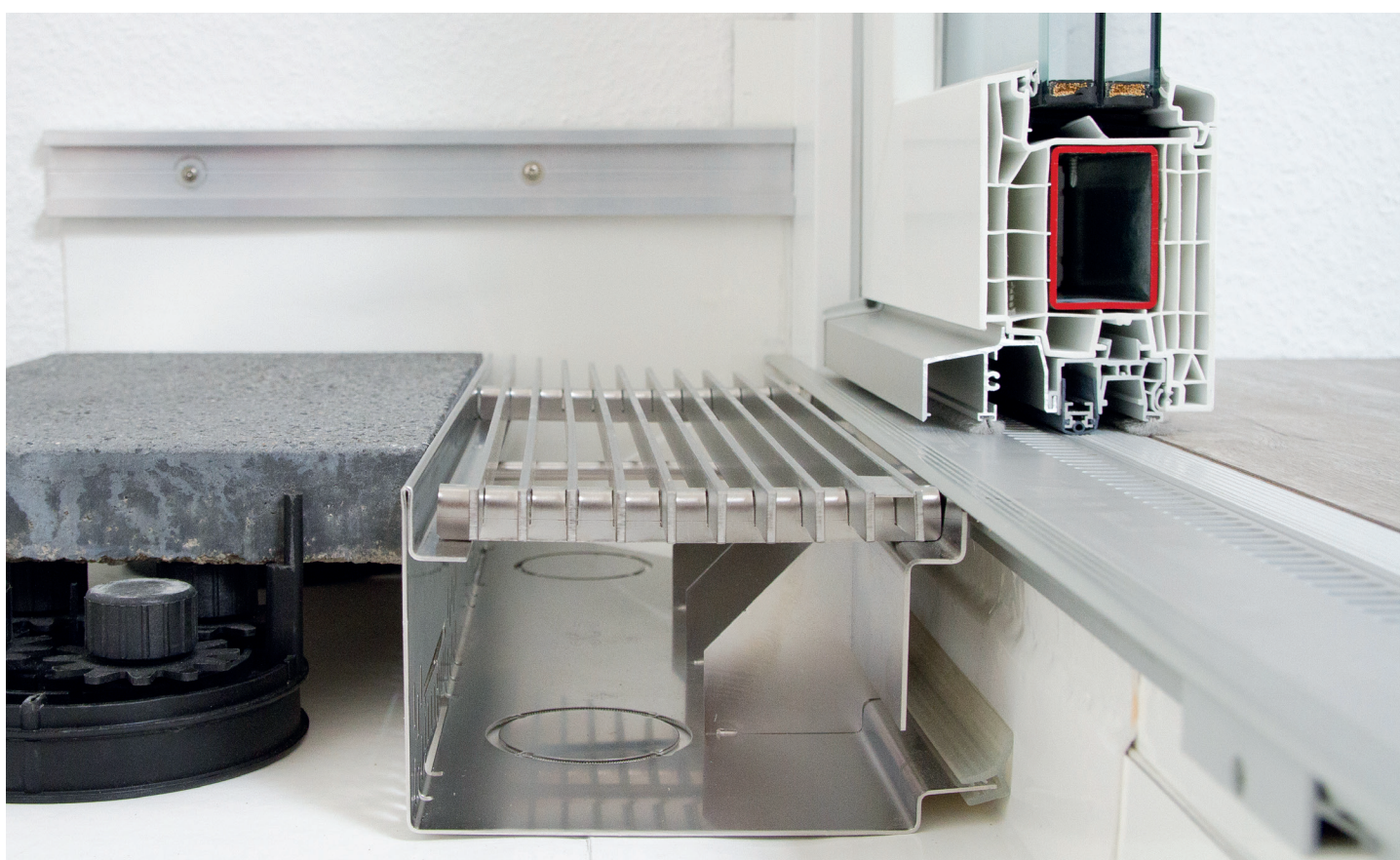

2

The first ever TÜV-tested, barrier-free transition for exterior doors, balconies, patios and terraces.

PremiPlan® – The premium system for maximum barrier-free access with floor-flush installation with zero millimetre upstand. Barrier-free accessibility and the transition between indoor and outdoor areas, combined with a high level of walking comfort, is one of the main current focal points in the field of comfortable and age-appropriate residential construction. The Profiline Group, Alwitra Flachdach-Systeme GmbH and ACO Hochbau Vertrieb GmbH, as premium manufacturers in this field, have now developed the PremiPlan® threshold system especially for this purpose and have had it successfully tested by TÜV Süd for utilisation in accordance with DIN 18040 - Part 1+2 under the highest requirements.



ACO Profiline Free functions

- 1 Ensuring that there is no threshold
- 2 Collecting any resulting rainwater from the façade
- 3 Draining the threshold system via the integrated system
- 4 Drainage via the lateral drain slots on waterproofed surface areas according to DIN 18531
- 5 Drainage via an outlet socket in areas in contact with the ground according to DIN 18533



- Fulfils the demands from DIN 18040
- Sealing according to DIN 18531/18533
- Waterproofing system from Alwitra

TÜV tested – Test report can be viewed at:
www.aco-hochbau.de/download/zertifikate

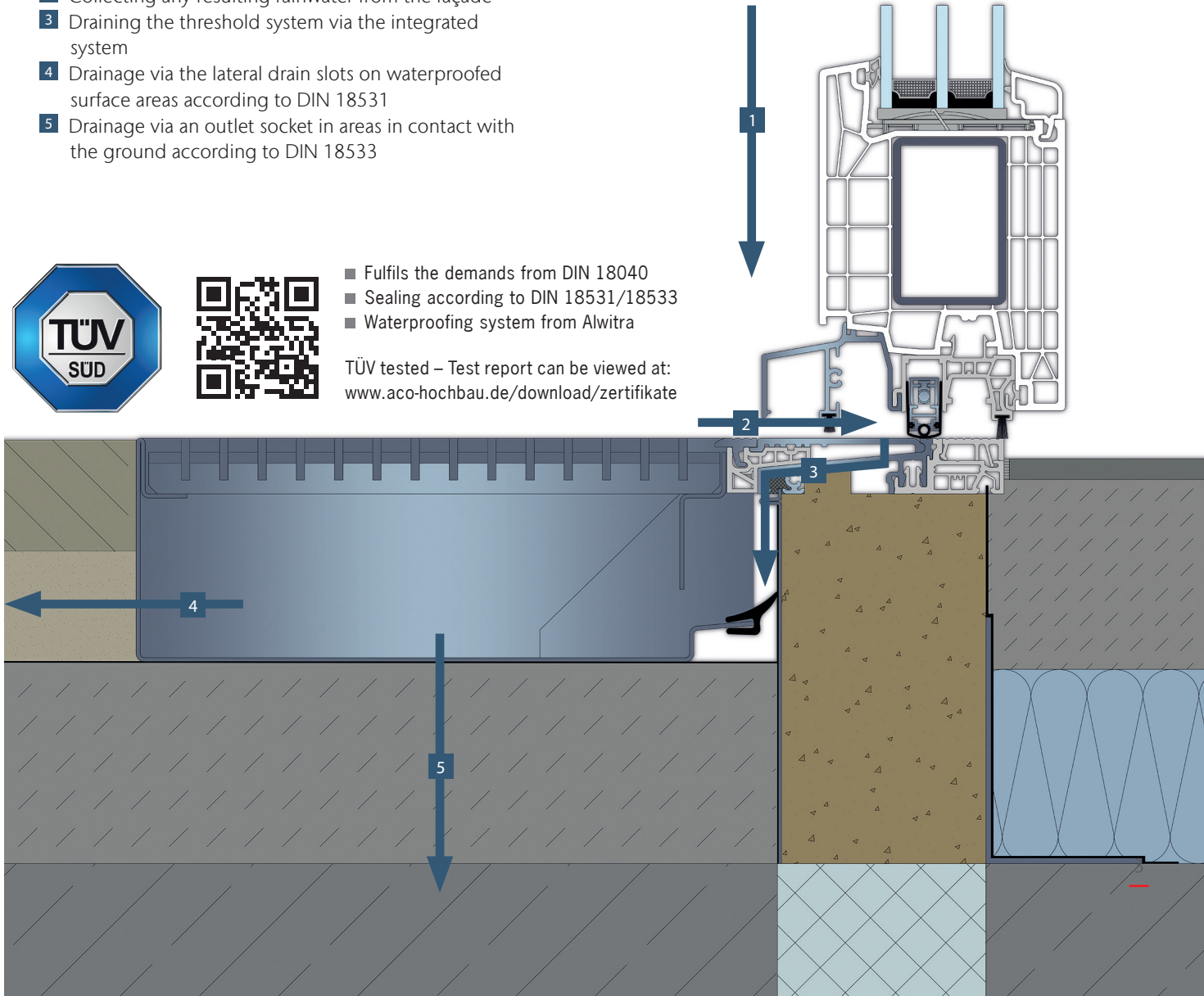

Grating cover

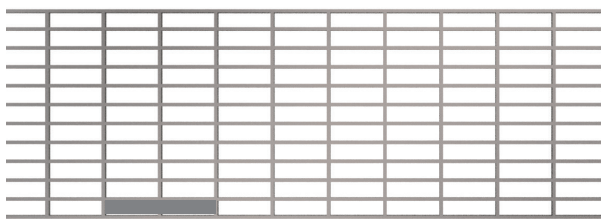

Mesh grating 30/10 in construction widths 150 mm and 200 mm,
Galvanised steel and stainless steel

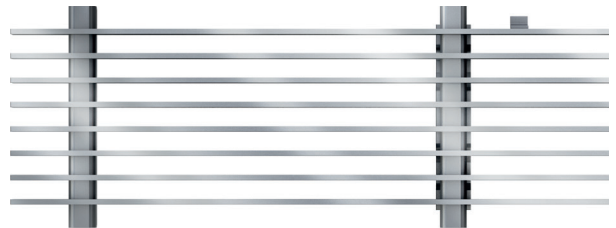

Longitudinal rod grating 3 x 15 in construction widths 150 mm and
200 mm, Galvanised steel and stainless steel

PremiPlan®

10 mm barrier-free threshold

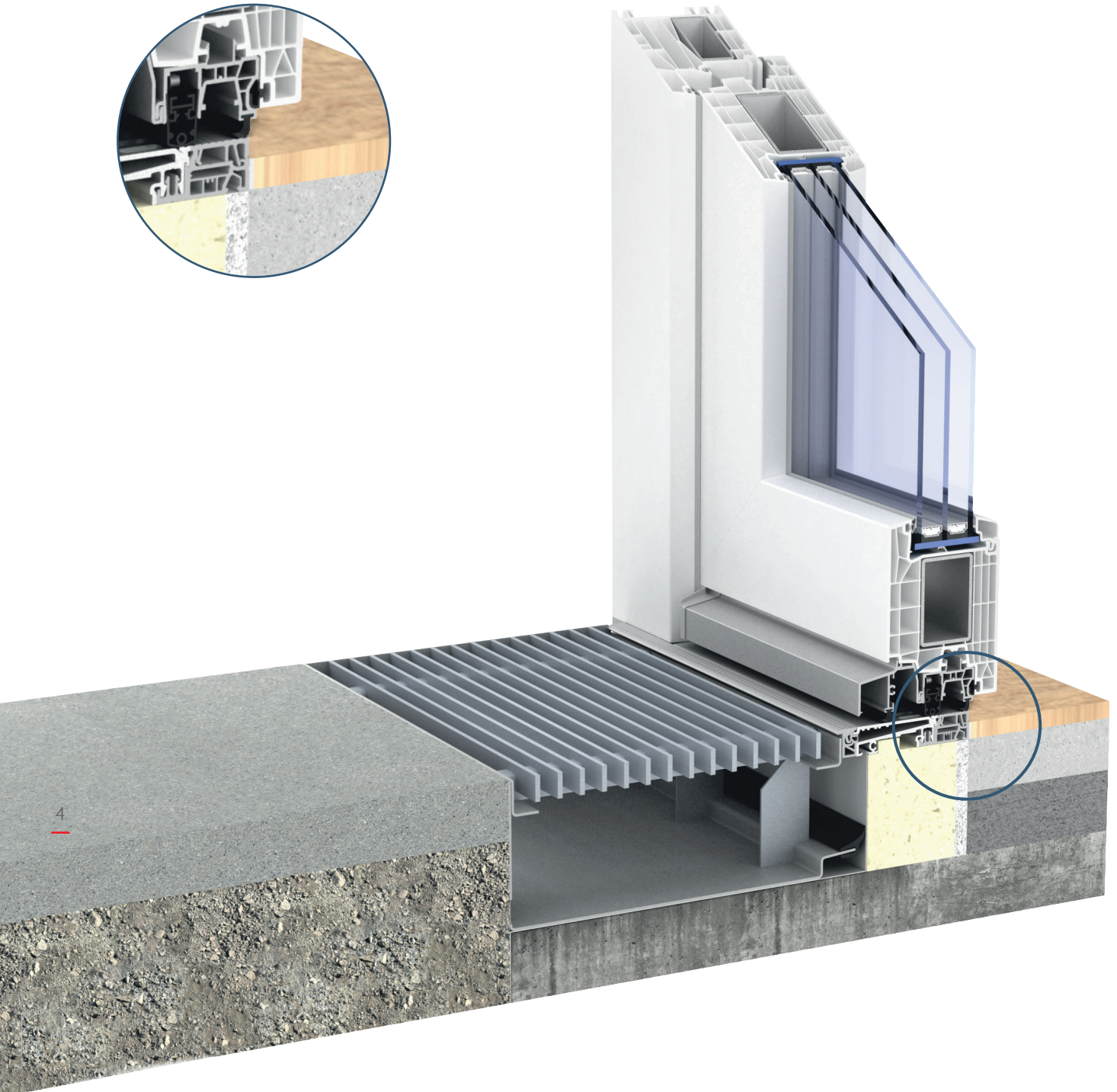
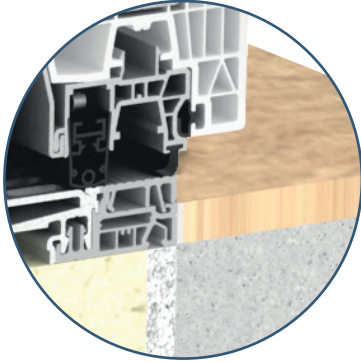

4

Implementing clever adaptation and utilising the previously tried and tested 20 mm threshold now enables all our entrance door, terrace and patio systems in the basic depths 76 and 88 to be transformed into barrier-free threshold solutions. In the case of door leaf profiles, the internal leaf overlaps are trimmed back and then fitted with a special rebate sealing strip.

Barrier-free i.e. threshold-free transitions from the living area to patio, terrace or balcony are now an integral part of the standard for upmarket residential design and construction. It must still however be ensured that no rainwater can penetrate into the building from the outside. PremiPlan® and PremiPlan® Plus can be installed in the area of flat roofs or near the ground and also in areas that come into contact with the ground.

PremiPlan® Plus

0 mm with lowerable comfort seal

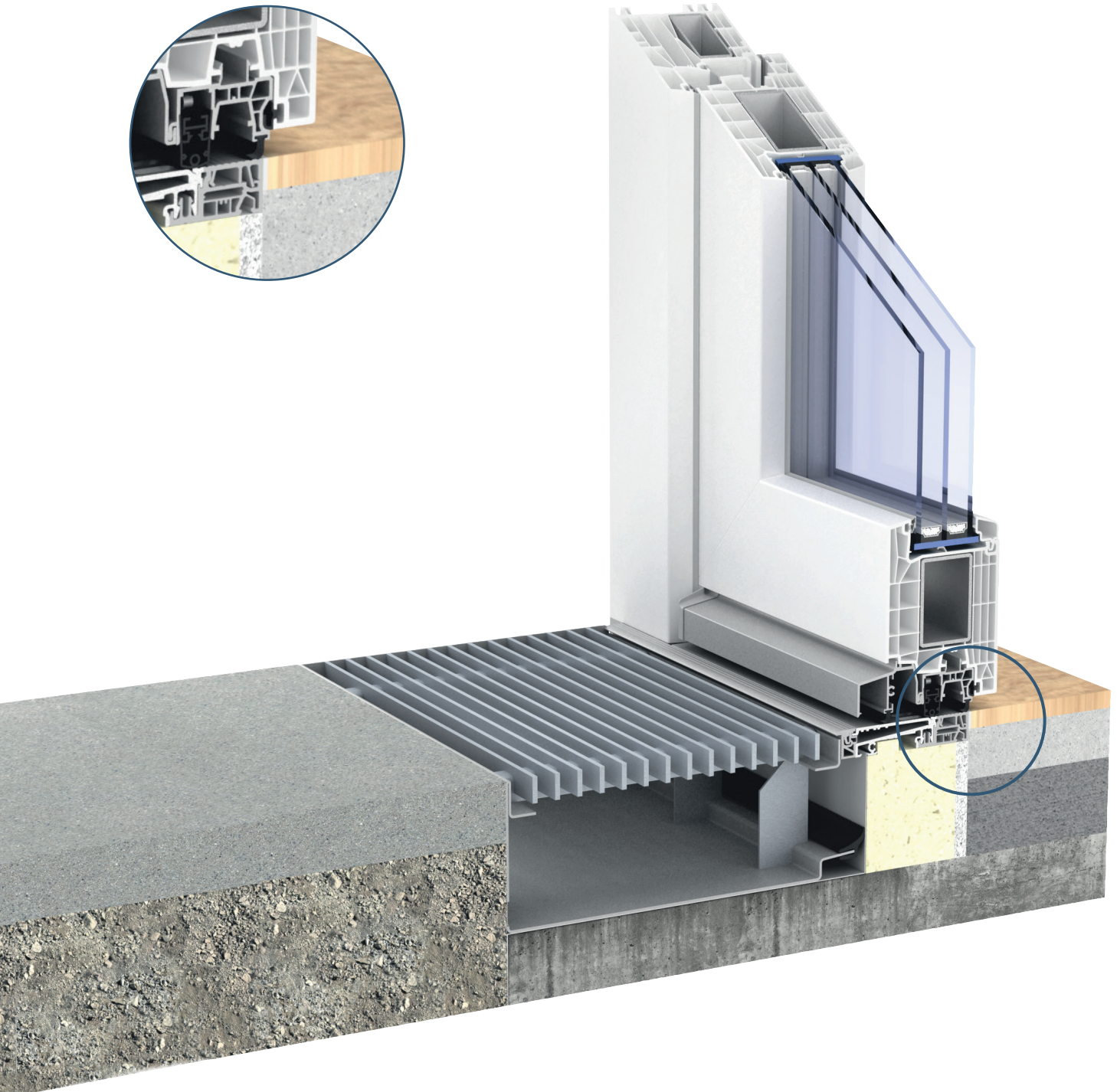
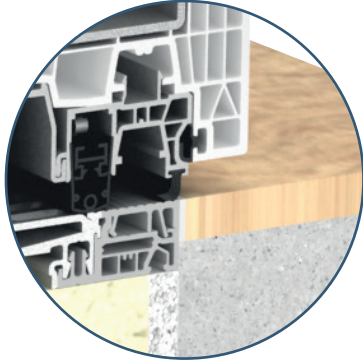

The premium threshold system for maximum barrier-free accessibility with high walking comfort due to the ground-level installation with zero millimetre upstand. A parallel lowerable floor seal is hereby a central component of a multi-stage, and continuous sealing concept, which therefore achieves maximum values by means of specially developed moulded parts.

The modular design and construction of the system enables efficient production and assembly. Both threshold systems can be utilised in the 88 MD window and front door systems and 76 rebate and centre seals for 1-leaf, inward opening elements. 2-leaf and outward opening elements are currently undergoing preliminary testing.

ACO Profiline Free – Roof design

DIN 18531

Made of hot-dip galvanised steel or stainless steel for the barrier-free door threshold area in accordance with DIN 18531 for inlaid gratings. Designed for patio, terrace and balcony doors for the PremiPlan® door threshold system.

Threshold connection with parallel-installed, continuous flexible seal for backflow-free connection to the threshold system. Open channel body with 4 mm drainage slots, branch duct connection and DN 100 connection possibility in the floor for balconies and roofs for foot traffic.

- Material: hot-dip galvanised steel or stainless steel V2A (1.301)
- Overall construction widths: 15.5 cm and 20 cm
- Overall construction height: 10 cm
- Overall construction length: 60 cm and 120 cm

Water level slope, accessible as well as accessible with a wheelchair

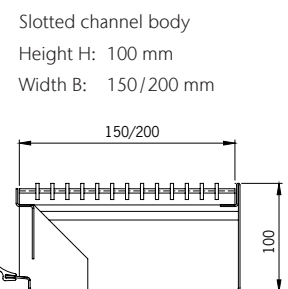
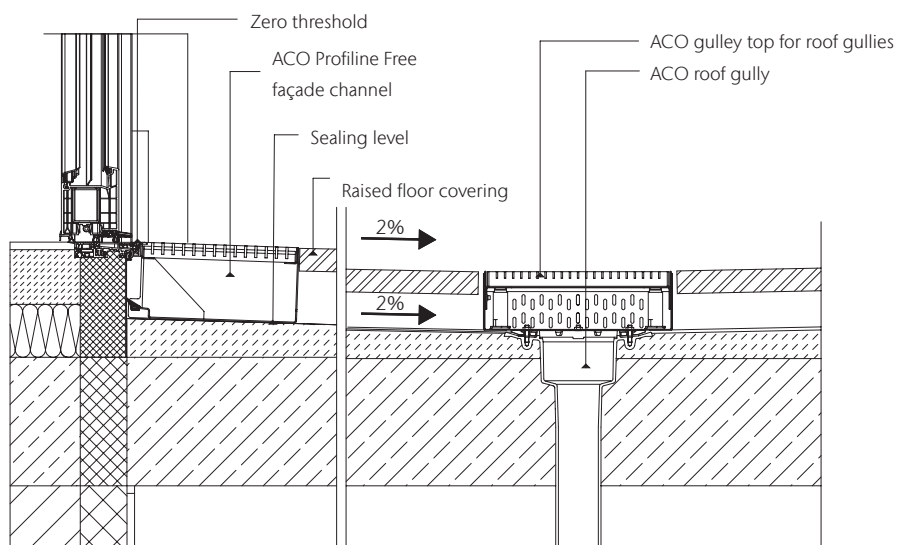
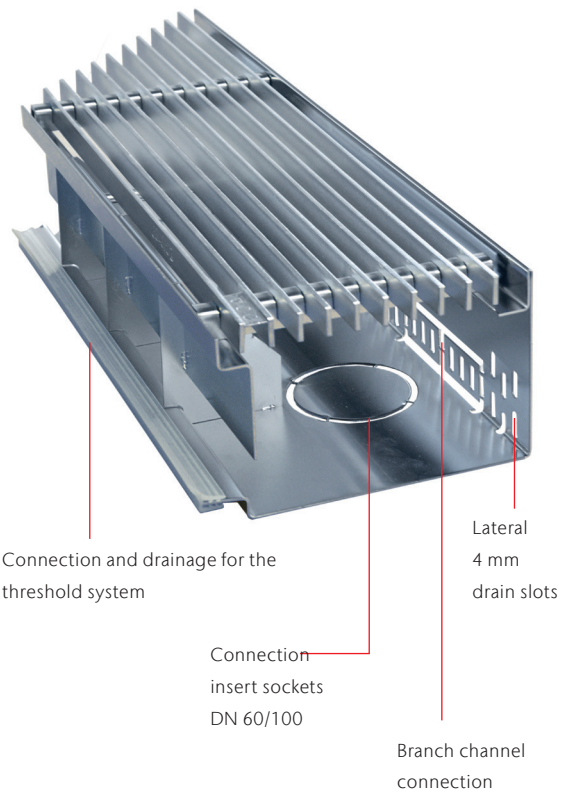

ACO Profiline Free – Contact with ground design

DIN 18533

Made of hot-dip galvanised steel or stainless steel for the barrier-free door threshold area in accordance with DIN 18533 for inlaid gratings. Designed for front entrance door and side entrance door for the PremiPlan® door threshold system.

Threshold connection with parallel-installed, continuous flexible seal for backflow-free connection to the threshold system. DN 50 closed channel body with connection possibility in ground for front entrance door areas.

- Material: hot-dip galvanised steel or stainless steel V2A (1.301)
- Overall construction widths: 15.5 cm and 20 cm
- Overall construction height: 10 cm
- Overall construction length: 60 cm and 120 cm

Water level slope, accessible as well as accessible with a wheelchair

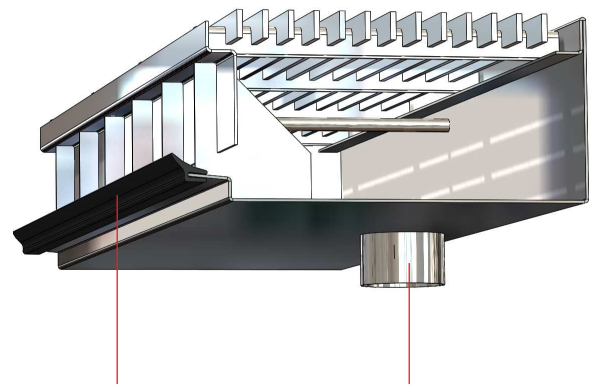

Connection and drainage for the threshold system

Connection DN 50

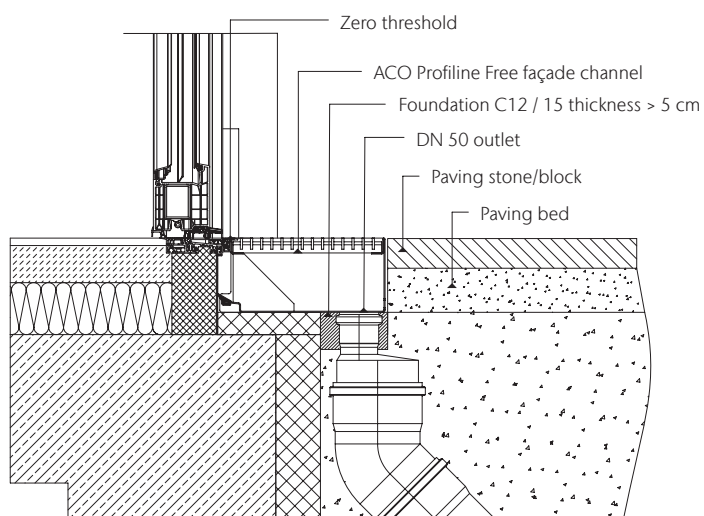

Channel body with DN 50 socket
Height H: 100 mm
Width B: 150/200 mm

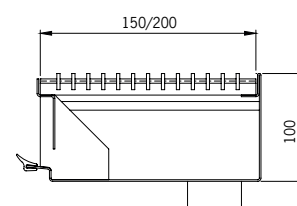

Every product from ACO Hochbau
supports the ACO system chain



System solutions for the basement

- Basement window
- Assembly panels for light wells
- Pressure water proof light wells
- Backflow systems

Infrastructure for house and garden

- Bath drainage
- Shaft covers
- Façade drainage channels
- Linear drainage
- Point drainage
- Doormats
- Infiltration
- Rainwater harvesting

Barn windows and escape doors

ACO Hochbau Vertrieb GmbH

Neuwirtshäuser Straße 14
97723 Oberthulba/Reith
Germany
Tel. +49 9736 41-60
Fax +49 9736 41-69

hochbau@aco.com
www.aco-hochbau.de

**ACO. creating
the future of drainage**

